

フィールドクリンブ用ホース金具

金具形状

KSF90

小松製作所

【特徴】
KES規格
標準圧カシリーズ
90°エルボ

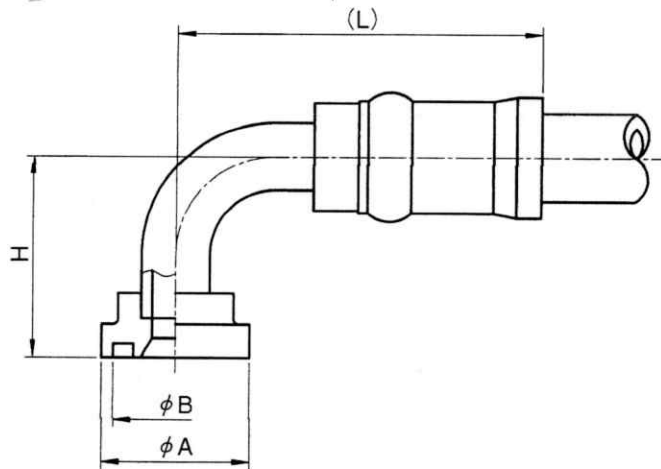

ホース内径 (小松 呼)	金具品番	A	B	H	L	リング	
12 (04)	GKCKSF90 12	30.2	25	42.0	84.5	P21	
	KKCKSF90 12AAA	30.2	25	130.5	72.5	P21	
	KKCKSF90 12AAB	30.2	25	85.0	73.5	P21	
15 (05)	GKCKSF90 15	34.2	28	55.0	108.5	P22A	
	GKCKSF90 -1210	38.1	31	55.0	108.5	P25	
	GKCKSF90 15AAA	44.5	38	60.0	105.5	P32	
19 (06)	GKCKSF90 19	38.1	31	55.0	115.0	P25	
	GKCKSF90 -1012	34.2	28	55.0	115.0	P22A	
	GKCKSF90 -1612	44.5	38	55.0	115.0	P32	
25 (10)	GKCKSF90 25	44.5	38	70.0	132.0	P32	
	GKCKSF90 -1216	38.1	31	55.0	122.0	P25	
	GKCKSF90 -2016	50.8	44	70.0	132.0	P38	
	GKCKSF90 25AAA	50.8	44	100.0	128.0	P38	
32 (12)	GKCKSF90 32	50.8	44	80.0	165.0	P38	
	GKCKSF90 -1620	44.5	38	70.0	150.0	P32	
	GKCKSF90 32AAA	50.8	44	110.0	165.0	P38	
	GKCKSF90 32AAB	50.8	44	130.0	143.0	P38	
	GNCKSF90 32	50.8	44	80.0	153.5	P38	
38 (14)	GKCKSF90 38	60.3	54	110.0	195.0	P48	
	GKCKSF90 -2024	50.8	44	80.0	185.0	P38	
	AKCKSF90 38	60.3	54	110.0	195.5	P48	
	GNCKSF90 38	60.3	54	110.0	171.5	P48	
50 (20)	GKCKSF90 50	71.4	65	140.0	249.0	G60	
	KKCKSF90 50	71.4	65	140.0	249.0	G60	
	GNCKSF90 50	71.4	65	140.0	249.0	G60	